



AMERICAN SPECIALTIES, INC.

441 Saw Mill River Road, Yonkers, NY 10701 (914) 476-9000

MODEL No: 107-1

ISSUED: 1-87

REVISED: 9-96

SECURITY FRAMED MIRROR WITH ROUNDED CORNERS - FRONT MOUNTED

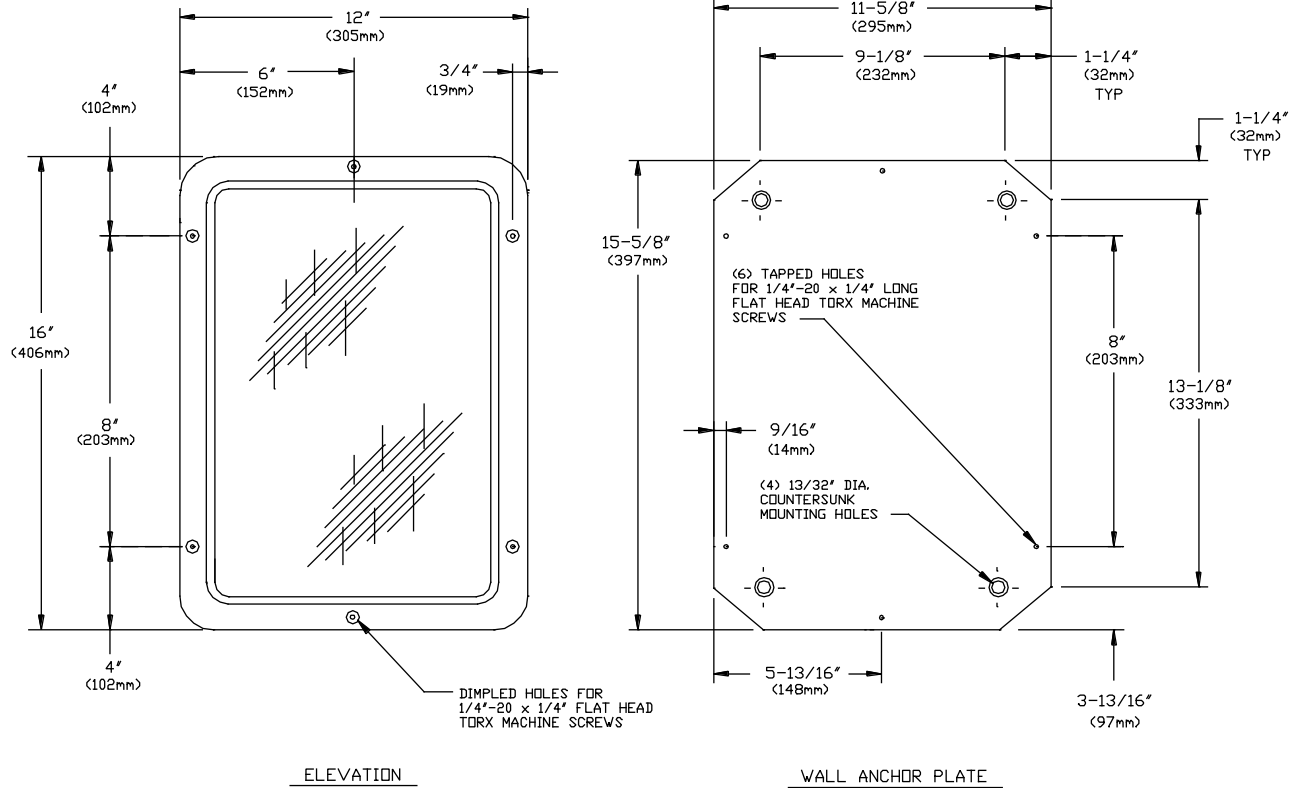

SPECIFICATION

Security Framed Mirror with Rounded Corners for Front Mounting to wall anchor plate shall be fabricated of one piece alloy 18-8 stainless steel, type 304, N^o 18 gauge with N^o 8 mirror polish. Installed unit shall project 7/16" (11mm) from wall. Frame shall be provided with six (6) dimpled holes for 1/4 - 20 x 3/8" long pin - Torx[®] flat head machine screws supplied. Wall anchor plate shall be fabricated of steel, N^o 7 gauge and shall be provided with four (4) 13/32" (10mm) dia. countersunk mounting holes for 1/4" FH screws and six (6) 1/4-20 tapped holes for mounting framed mirror.

Security Framed Mirror with Rounded Corners - Front Mounted shall be Model N^o 107-1 as fabricated by American Specialties, Inc., 441 Saw Mill River Road, Yonkers, New York 10701-4913

INSTALLATION

For Compliance with ADA Accessibility Guidelines, install unit so that bottom edge of reflecting surface is 40" (1016mm) max. above finished floor. Surface mount wall anchor plate with four (4) screws through countersunk mounting holes provided. Mount and secure framed mirror to wall anchor plate with six (6) 1/4 - 20 x 3/8" long pin-Torx[®] flat head machine screws (supplied) through dimpled holes in frame into tapped holes provided in wall plate.

GLAZING OPTIONS

Various gauges and types of steel with different finishes are available. See security section in **MIRROR GLAZING OPTIONS**. For 20ga. mirror with a N^o 8 mirror polish finish specify option by adding suffix to Model N^o (e.g. 107-1-14).

Accessory Specialties

AMERICAN DISPENSER

Desert Ray Products

WATROUS INC.